

# MCQA 系列 (φ 40~ φ 100)

標準氣壓缸-不附磁石

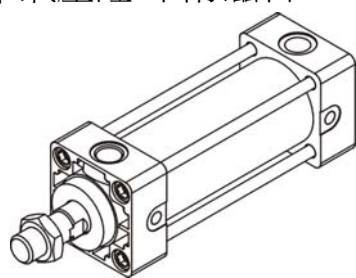

## MCQA-11 系列

單位: kg

內徑	φ 40	φ 50	φ 63	φ 80	φ 100
行程					
0 mm	0.760	1.070	1.460	2.710	3.970
25 mm	0.090	0.120	0.130	0.220	0.280
25 mm	0.850	1.190	1.590	2.930	4.250
50 mm	0.940	1.310	1.720	3.150	4.530
100 mm	1.120	1.550	1.980	3.590	5.090
150 mm	1.300	1.790	2.240	4.030	5.650
200 mm	1.480	2.030	2.500	4.470	6.210
250 mm	1.660	2.270	2.760	4.910	6.770
300 mm	1.840	2.510	3.020	5.350	7.330
350 mm	2.020	2.750	3.280	5.790	7.890
400 mm	2.200	2.990	3.540	6.230	8.450
450 mm	2.380	3.230	3.800	6.670	9.010
500 mm	2.560	3.470	4.060	7.110	9.570
600 mm	2.920	3.950	4.580	7.990	10.690
700 mm	3.280	4.430	5.100	8.870	11.810
800 mm	3.640	4.910	5.620	9.750	12.930
900 mm	4.000	5.390	6.140	10.630	14.050
1000 mm	4.360	5.870	6.660	11.510	15.170
配件	φ 40	φ 50	φ 63	φ 80	φ 100
LB × 2pcs	0.213	0.237	0.446	0.951	1.212
CA	0.297	0.411	0.630	1.192	1.820
CB	0.295	0.407	0.650	1.178	1.822
FA / FB	0.162	0.184	0.346	-	-
FAC / FBC	0.482	0.584	1.012	1.922	2.490
TA / TB / TC	0.420	0.455	0.815	1.600	2.380
Y	0.200	0.285	0.285	0.518	0.746
I	0.158	0.222	0.222	0.485	0.670
桿前 NUT	0.020	0.030	0.030	0.050	0.060

# MCQA 系列 (φ 40~ φ 100)

標準氣壓缸-附磁石

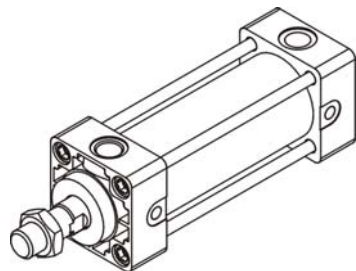

## MCQA-11-M 系列

單位: kg

內徑	φ 40	φ 50	φ 63	φ 80	φ 100
行程					
0 mm	0.772	1.087	1.480	2.737	4.005
25 mm	0.090	0.120	0.130	0.220	0.280
25 mm	0.862	1.207	1.610	2.957	4.285
50 mm	0.952	1.327	1.740	3.177	4.565
100 mm	1.132	1.567	2.000	3.617	5.125
150 mm	1.312	1.807	2.260	4.057	5.685
200 mm	1.492	2.047	2.520	4.497	6.245
250 mm	1.672	2.287	2.780	4.937	6.805
300 mm	1.852	2.527	3.040	5.377	7.365
350 mm	2.032	2.767	3.300	5.817	7.925
400 mm	2.212	3.007	3.560	6.257	8.485
450 mm	2.392	3.247	3.820	6.697	9.045
500 mm	2.572	3.487	4.080	7.137	9.605
600 mm	2.932	3.967	4.600	8.017	10.725
700 mm	3.292	4.447	5.120	8.897	11.845
800 mm	3.652	4.927	5.640	9.777	12.965
900 mm	4.012	5.407	6.160	10.657	14.085
1000 mm	4.372	5.887	6.680	11.537	15.205