

Order example

MPM – 20 – S



MODEL

MPM	
MPF	
MPH	
MPP	

MATERIAL

S: Steel
B: Brass

20
30
40

MPM (Male screw)

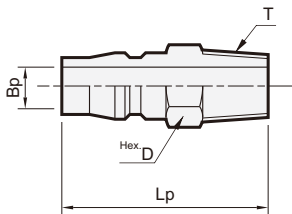

Model	Screw size T	Dimension (mm)			Weight (g)	
		Bp	Hex. D	Lp	Steel	Brass
MPM-20	R1/4	φ 7.5	Hex. 14/16.2	41	25	27
MPM-30	R3/8	φ 7.5	Hex. 17/19.6	43	40	45
MPM-40	R1/2	φ 7.5	Hex. 21/24.2	46	65	70

MPF (Female screw)

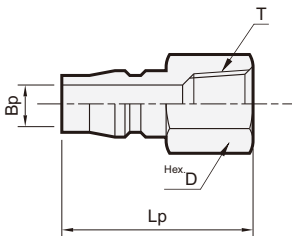

Model	Screw size T	Dimension (mm)			Weight (g)	
		Bp	Hex. D	Lp	Steel	Brass
MPF-20	Rc1/4	φ 7.5	Hex. 17/19.6	38	30	32
MPF-30	Rc3/8	φ 7.5	Hex. 21/24.2	41	45	48
MPF-40	Rc1/2	φ 7.5	Hex. 26/30	43	65	70

MPH (Hose screw)

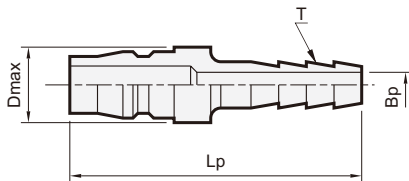

Model	Hose size T	Dimension (mm)			Weight (g)	
		Bp	D _{max}	Lp	Steel	Brass
MPH-20	5/16"Hose	φ 5	φ 16	58	27	29
MPH-30	3/8"Hose	φ 7.5	φ 16	62	35	38
MPH-40	1/2"Hose	φ 7.5	φ 18	64	50	55

MPP (Nut style)

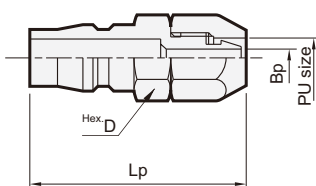

Model	PU size ID × OD (mm)	Dimension (mm)			Weight (g)	
		Bp	Hex. D	Lp	Steel	Brass
MPP-20	5 × 8	φ 4	Hex. 14/16.2	42.5	30	33
MPP-30	6.5 × 10	φ 5	Hex. 16/18.2	44.5	40	43
MPP-40	8 × 12	φ 6	Hex. 17/19.2	45	40	43